

31.89100.22

Hydraulic hinge Biloba BL 8910 with double-sided lug

Material:	aluminium
Finish:	natural anodized EV1
Mounting:	glass/wall
Glass thickness:	8 - 13.52 mm
Sales unit (SU):	St
Unit package:	1.00
Shape:	square
Carrying capacity:	100 kg/pair

infinitely adjustable in the zero position, concealed screw connection, with adjustable closing speed, with 0° / +90° / -90° detent, max. door width 1000 mm, automatic closing from +80° and -80°, for temperatures from -15°C to +40°C. Note: Forced opening above 95° could lever the door open, we recommend installing a door stopper





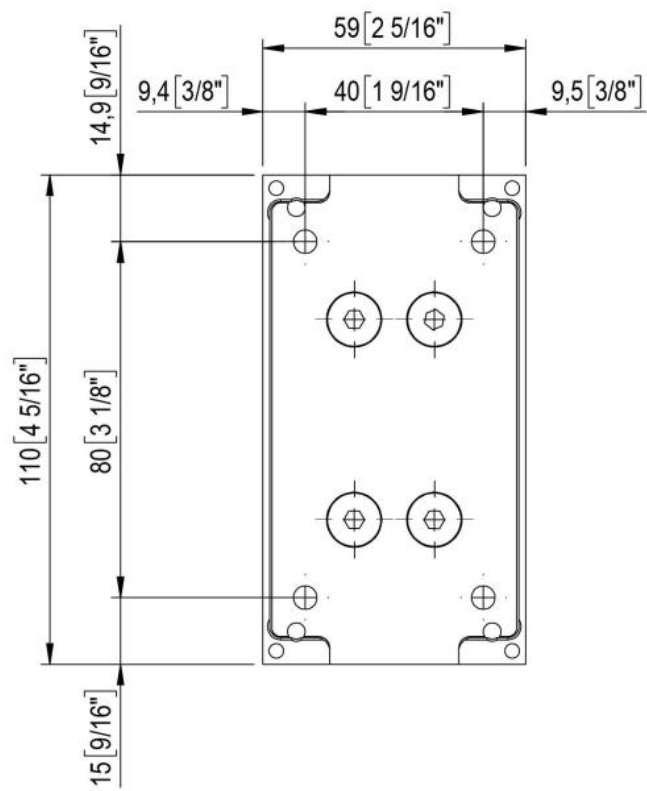
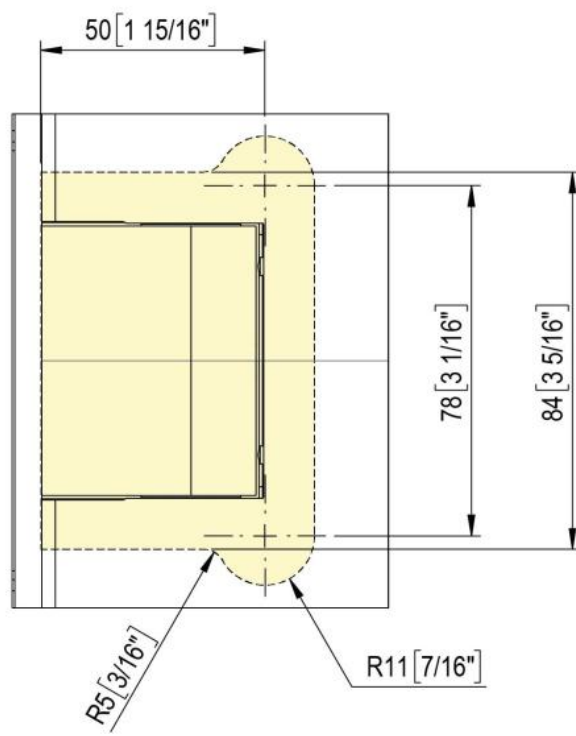

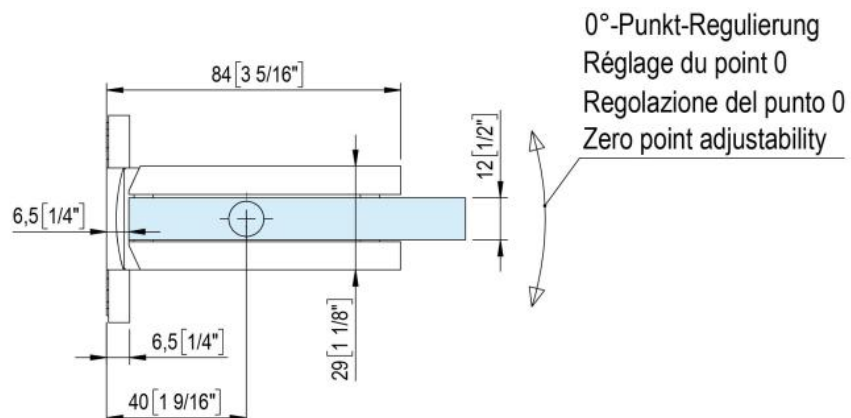

Einstellung Schliessgeschwindigkeit
 Réglage de la vitesse de fermeture
 Valvola di regolazione velocità chiusura anta
 Adjustment valve for the door's closing speed

