

## 31.80101.18

Hydraulic hinge Biloba BL 8010 BT JC with double-sided bracket also for saunas, steam rooms and swimming pools

Material: inox V4A  
Finish: BlackLine RAL 9005 matt  
Mounting: glass/wall  
Glass thickness: 8 - 13.52 mm  
Sales unit (SU): St  
Unit package: 1.00  
Carrying capacity: 100 kg/pair

infinitely adjustable in the zero position, concealed screw connection, with adjustable closing speed, with 0° / +90° / -90° detent, max. door width 1000 mm, automatic closing from +80° and -80°, for temperatures from -15°C to +100°C. Note: Forced opening above 95° could lever the door open, we recommend installing a door stopper. For doors less than 500 mm wide, please use the hinge combination BL 8010 BT JC and BL 8010 BT JC SOL. O-ring seals of the hydraulic circuit made of Viton, spindle made of stainless steel AISI 420, inner body anodised with special deep oxidation (20 microns)





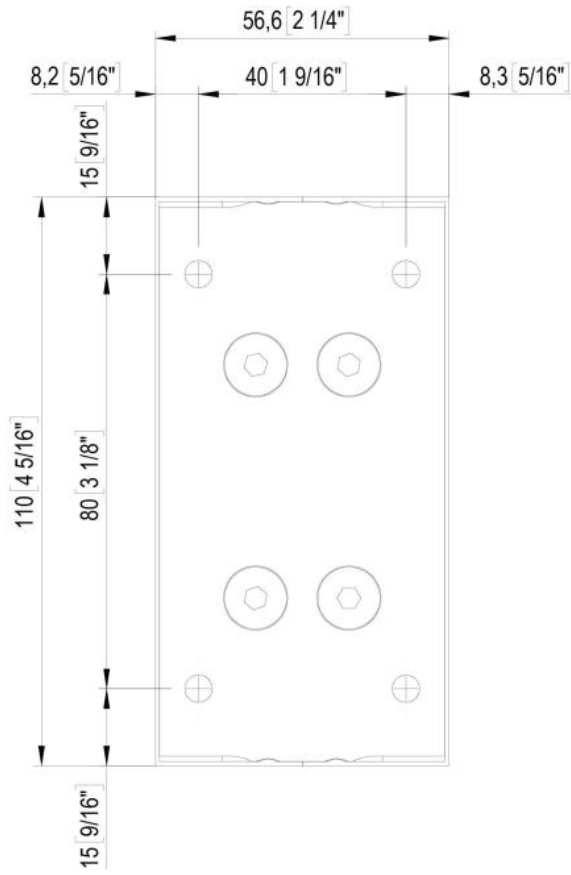
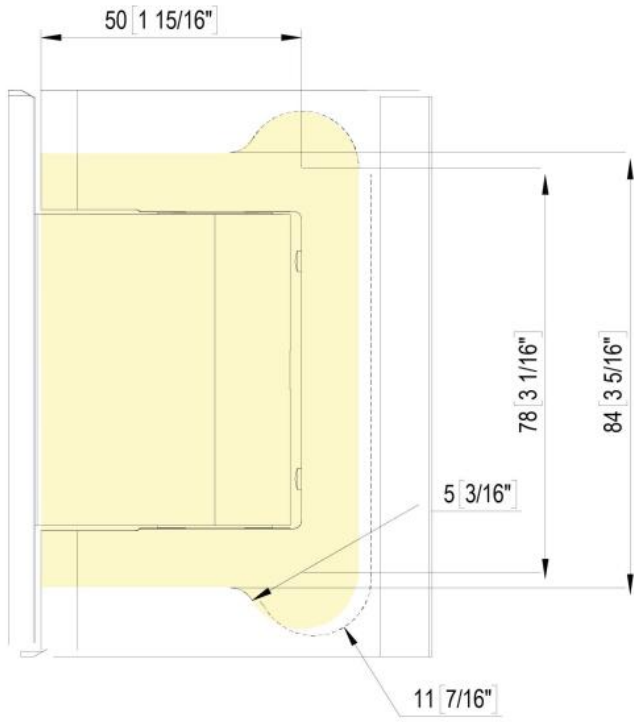

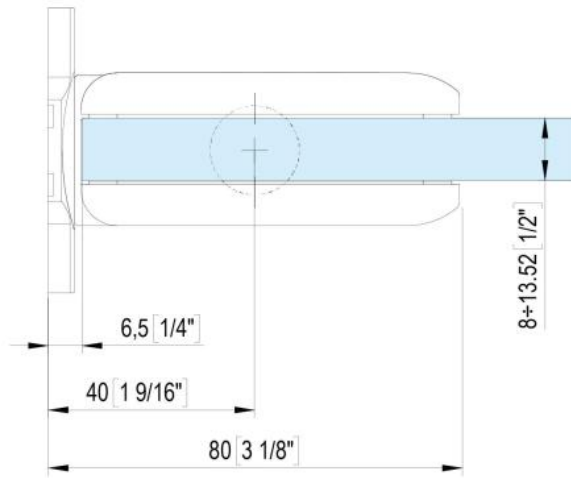

Einstellung der Schließgeschwindigkeit der Tür  
 Réglage de la vitesse de fermeture de la porte  
 Valvola di regolazione velocità chiusura anta  
 Adjustment valve for the door's closing speed

