

## 57.50041.81

### Pull handle (solid wood and stainless steel black)

Material: beech  
Finish: oiled  
Mounting: glass assembly (pair)  
Glass thickness: 8 - 13.52 mm  
Sales unit (SU): Pr  
Unit package: 1.00  
Shape: round  
Measures: Ø 30 mm, L = 300 mm  
Measure A: 300 mm  
Measure B: 200 mm  
Measure C: 45 mm  
Measure D: 30 mm  
Glass processing: Glass drill hole : Ø13 mm

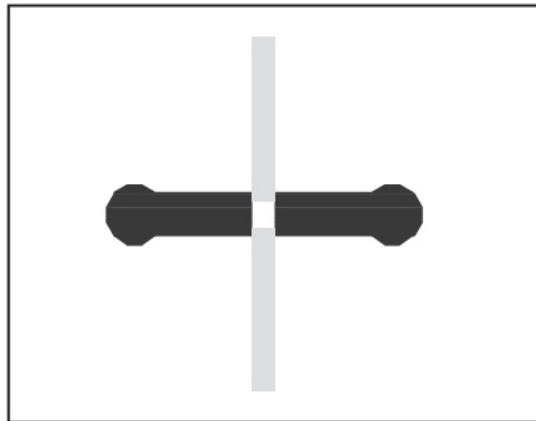

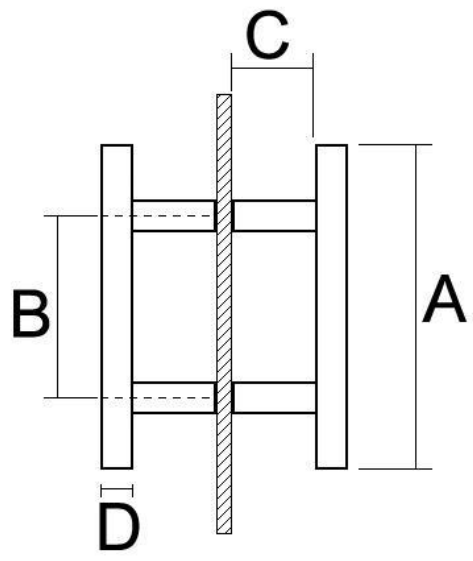

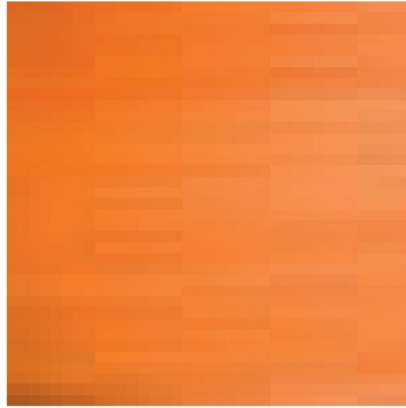

Buche / hêtre